

Name	No-su18		
Location	Kita-ku, kita 18-jo nishi 6-chome 1-13		
Construction	Built in 3/1984, concrete, 4 stories, 27 units	type	intermediary

Contract Period	Bathroom/Toilet	Heater	Gas	Internet
2 years	together	Gas FF	City Gas	Free

Available Date	Room Number	Floor	Layout	Facing	Rent Fee	Deposit Key money	Managem t Fee
						0・0	3,000
※Rent fee will be increased by 1,000 yen for 1 year							

<b>Initial Cost</b>	Deposit	0 month
	Key money	0 month
	Rent fee in advance	1 month
	Management fee	1 month
	Water Bill	2,200 円
	Cleaning fee	28,600 円
	24h management fee	1,000 円
※Payment Commissio	As below	
Contract administration fee	5,500 円	

<b>Monthly Cost</b>	Rent fee	As above
	Management Fee	As above
	Water Bill	2,200 円
	Electricity	Consumptior
	Gas	Consumptior
	24h management fee	1,000 円
	※Payment Commissio	As below

<b>Others</b>	Water bill: 2,200 yen
	【When using a guarantee company】Initial guarantee fee 10,000 yen(No renewal fee for the first time only) and payment commission (rent fee+management fee+water bill+24h management fee+association fee) × 1.5% should be paid to guarantee company directly.

<b>Facilities</b>	Gas hot water supply/Free WIFI/Washing machine/Refrigerator/Microwave/Gas stove
	Rice cooker/Vacuum cleaner/Bed/mattress/TV/TV table/Table/Curtain/Kettle
	Iron/Dryer/Pipe hanger/Lighting/Closet/Gas type heater/desk/chair

<b>Common facilities</b>	Outdoor bicycle parking lot (Free)
--------------------------	------------------------------------

- ~ Recommended points ~ **City Gas!!**  
 ★ With furniture and home appliances !! Monthly support is also possible  
 ★ Free WiFi!!!  
 ~ Neighborhood information ~  
 ○ Hokkaido University (18-jo gate) ..... 2mins by walk  
 ○ Namboku Line 「Kita 18-jo station」 ..... 5mins by walk  
 ..... 5mins by walk



※Only examples. The drawings are handwritten and the current status is give

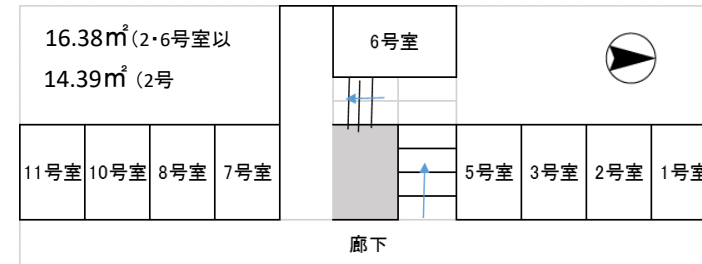

※Photos are from room 202.



## 北海道大学生活協同組合 ルームガイド

TEL:011-758-9550 FAX: 011-768-8907

北海道知事 石狩(9)第5076号

〒060-0808 北海道札幌市北区北8条西7丁目1-1 クラークサービスセンター2F

Mail:guide@hokudai-roomguide.net