

Name	Yamazaki Biru		
Location	Kita-ku, kita 14-jo nishi 1-chome 2-8		
Construction	Built in Feb. 1986, concrete, 4 stories, 23 units	type	intermediary

Contract Period	Bathroom/Toilet	Heater	Gas	Internet
2 years	Not separate	Gas FF	City gas	J:COM (Free)

Available Date	Room Number	Floor	Layout	Facing	Rent Fee	deposit key money	Management Fee
					34,000yen	0・0	3000 yen
For 1 year contract, the rent fee will be higher for 1,000yen.							

Initial Cost	Deposit	0 Month
	Key money	0 Month
	Rent fee in advance	1 Month
	Water Bill	1 Month
	Cleaning Fee	28600 yen
	24h management fee	1,000 yen
	Handing Fee	5,500 yen

Monthly Cost	Rent fee	34,000 yen
	Management Fee	3000 yen
	Water Bill	2,400 yen
	Electricity	Consumption
	Gas	Consumption
	24h management fee	1,000 yen

Others	Water bill is fixed: 2,400yen (with tax) 【When using a guarantee company】Initial guarantee fee 10,000 yen(No renewal fee for the first time only) and payment commission (rent fee+management fee+water bill+24h management fee+association fee) × 1.5% should be paid to
--------	--

Facilities	Gas hot water supply/Gas FF heater/Air conditioner/Bed(single)/Mattress/Desk/ Chair/TV stand/Curtains/Closet/Lighting/Refrigerator/Microwave/Rice cooker/ Vacuum cleaner (Free option : TV/Kettle/Iron/Ironing board/Hair dryer)
------------	--

Common facilities	Indoor bike parking lot(Free)/Coin laundry(On 1st floor)/J:COM(Free)/Intercom system/Delivery box
-------------------	---

~ Recommended points ~

★ Air conditioner compatible!!!

★ Economic city gas!!

~ Neighborhood information ~

○ Hokkaido University (13-jo gate) 5mins by walk

○ Namboku Line 「Kita 12-jo station」..... 5mins by walk

○ Supermarket Coop Sapporo 3mins by walk

City Gas!!

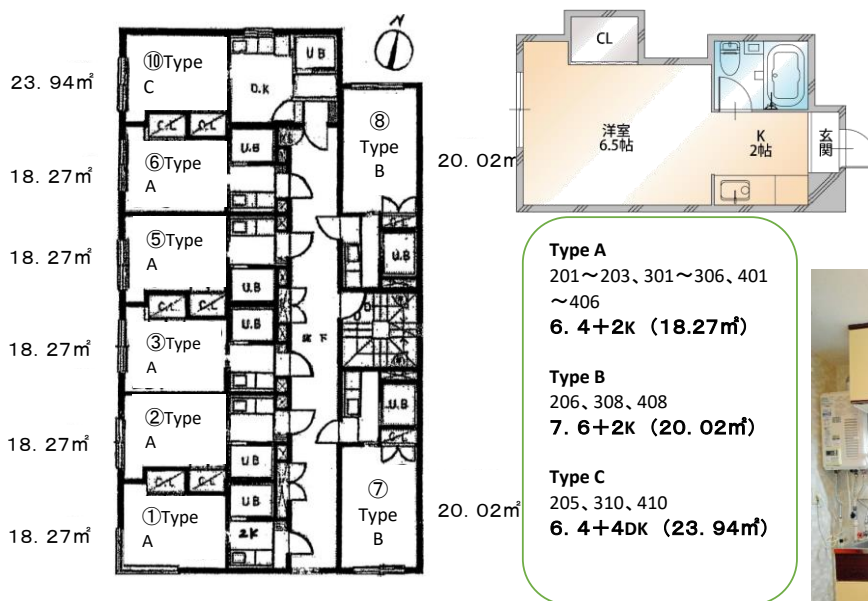

- Type A**
201~203, 301~306, 401~406
6.4+2K (18.27m²)
- Type B**
206, 308, 408
7.6+2K (20.02m²)
- Type C**
205, 310, 410
6.4+4DK (23.94m²)



※Only examples. The drawings are handwritten and the current status is give



※With home appliances and

北海道大学生生活協同組合 ルームガイド

免許番号: 北海道知事 石狩(9)第5076号

〒060-0808 北海道札幌市北区北8条西7丁目1-1 クラークサービスセンター2F

TEL: 011-758-9550 FAX: 011-768-8907

Mail: guide@hokudai-roomguide.net