

Name	<b>Yamazaki Biru</b>
Location	<b>Kita-ku, kita 14-jo nishi 1-chome 2-8</b>
Construction	Built in Feb. 1986, concrete, 4 stories, 23 units

Contract Period	Bathroom/Toilet	Heater	Gas	Internet
2 years	Not separate	Gas FF	City gas	J:COM (Free)

Available Date	Room Number	Floor	Layout	Facing	Rent Fee	deposit key money	Management Fee
					Rent Fee 34,000yen	0・0	3000 yen
<b>For 1 year contract, the rent fee will be higher for 1,000yen.</b>							

<b>Initial Cost</b>	Deposit	0 Month
	Key money	0 Month
	Rent fee in advance	1 Month
	Water Bill	1 Month
	Cleaning Fee	28600 yen

<b>Monthly Cost</b>	Rent fee	As Above
	Management Fee	3000 yen
	Water Bill	2,400 yen
	Electricity	Consumption
	Gas	Consumption

<b>Others</b>	Water bill is fixed: 2,400yen (with tax)
---------------	--

<b>Facilities</b>	Gas hot water supply/Gas FF heater/Air conditioner/Bed(single)/Mattress/Desk/
	Chair/TV stand/Curtains/Closet/Lighting/Refrigerator/Microwave/Rice cooker/
	Vacuum cleaner (Free option : TV/Kettle/Iron/Ironing board/Hair dryer)

<b>Common facilities</b>	Indoor bike parking lot(Free)/Coin laundry(On 1st floor)/J:COM(Free)/
	Intercom system/Delivery box

~ Recommended points ~

★ Air conditioner compatible!!!

★ Economic city gas!!

~ Neighborhood information ~

○ Hokkaido University (13-jo gate) ..... 5mins by walk

○ Namboku Line 「Kita 12-jo station」..... 5mins by walk

○ Supermarket Coop Sapporo ..... 3mins by walk

**City Gas!!**

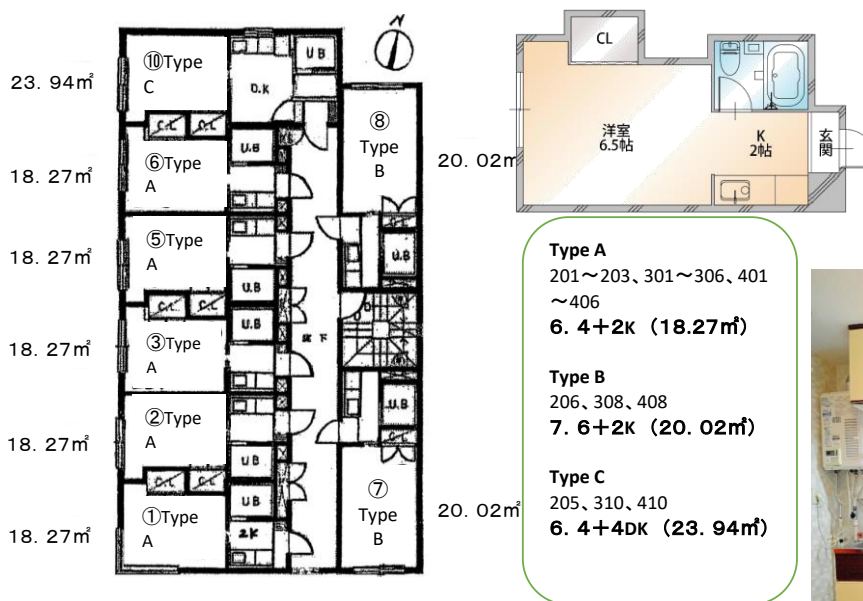

- Type A**  
201~203, 301~306, 401~406  
**6. 4+2K (18.27m²)**
- Type B**  
206, 308, 408  
**7. 6+2K (20.02m²)**
- Type C**  
205, 310, 410  
**6. 4+4DK (23.94m²)**



※Only examples. The drawings are handwritten and the current status is give



※With home appliances and